

UNIT 16

BIRCHMOSS

INDUSTRIAL STORAGE DEPOT

ECHT, WESTHILL, ABERDEENSHIRE, AB32 6XL



14 METRE
EAVES



25 AND 110
TONNE CRANES



COMPRESSOR



2 NO. 5T
PEDESTAL CRANES



2 TEST PITS

UNIT 16 COMPRISES A DETACHED INDUSTRIAL UNIT WITH TWO STOREY OFFICES AND LARGE SECURE YARD.

SCHEDULE OF ACCOMMODATION

(Approximate GIA)

Warehouse	2,194.18 sq m	(23,618 sq ft)
Office	348.03 sq m	(3,746 sq ft)
TOTAL	2,542.21 sq m	(27,364 sq ft)
Tarmac Yard	4,358.46 sq m	(46,914 sq ft)

Ample car parking is provided

SPECIFICATION

- › 14 metre eaves
- › 3 roller shutter doors
- › 25 and 110 Tonne crane
- › 2 no. 5 Tonne pedestal crane
- › Compressor
- › 2 test pits (18.25 m x 2.20m x 1.6m deep)
(6.5m x 6m x 5.8m deep)
- › Floor loading of 112 Kn/m²
- › Tarmac surfaced forecourts

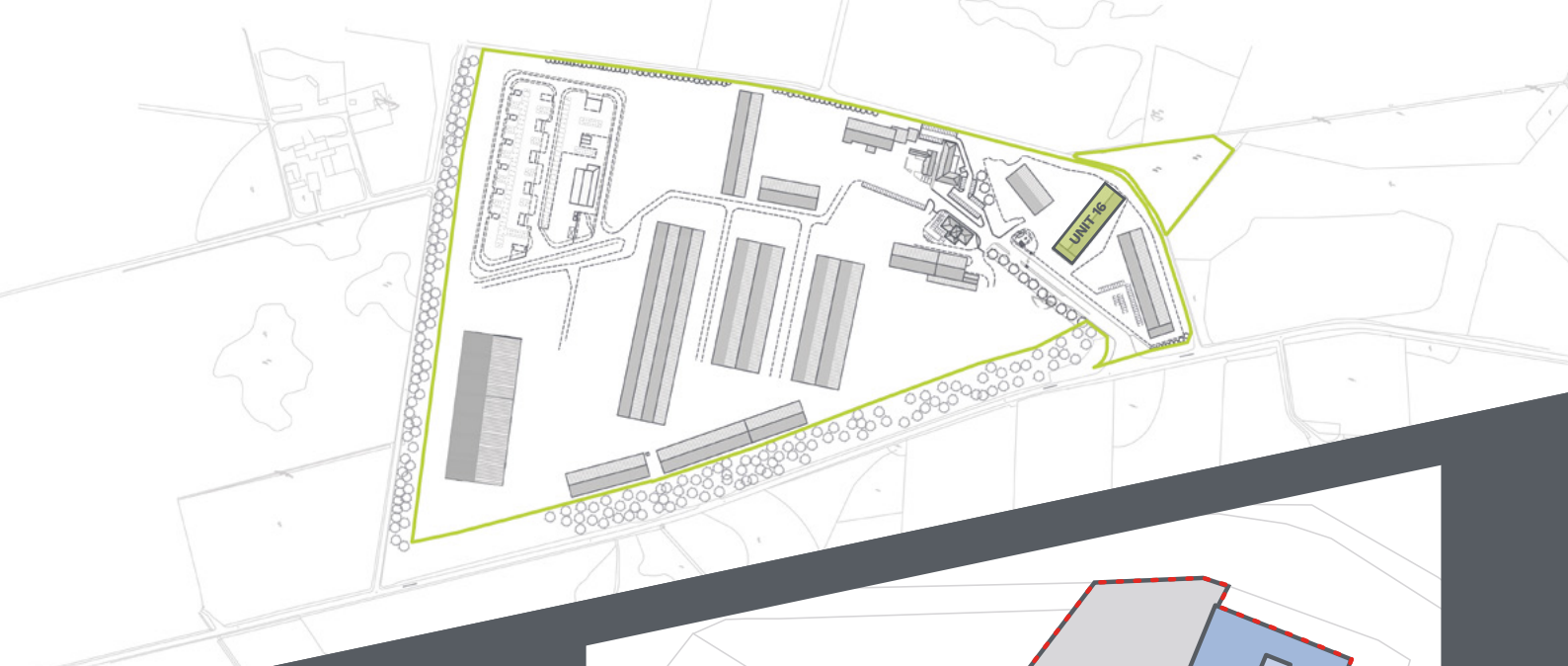

UNIT 16 BIRCHMOSS INDUSTRIAL STORAGE DEPOT

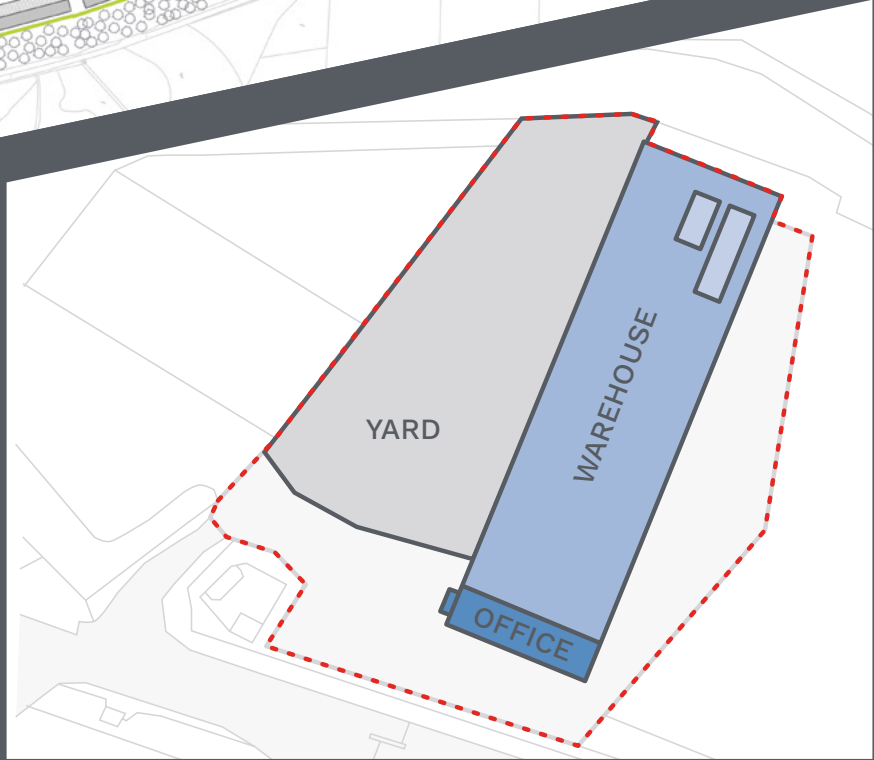

■ TEST PIT

TERMS

Available on leasehold terms. Packages can be tailored to suit an occupiers exact requirements.

RATEABLE VALUE

Further information available upon request.

ENERGY PERFORMANCE CERTIFICATE

The property has an EPC Rating of B-23. Full documentation is available upon request

ENTRY

The property is currently held on an existing lease expiring July 2018. Early entry may be possible by way of agreement with the sitting tenant.



ALL ENQUIRIES

Iain Landsman
iain.landsman@cbre.com

Gordon Pirie
Gordon.pirie@cbre.com

DISCLAIMER. CBRE on its behalf and for the Vendors or Lessors of this property, whose Agents they are, give notice that: These particulars are set out as a general outline only for guidance to intending Purchasers or Lessees, and do not constitute any part of an offer or contract. Details are given without any responsibility and any intending Purchasers, Lessees or Third Parties should not rely on them as statements or representations of fact, but must satisfy themselves by inspection or otherwise as to the correctness of each of them. No person in the employment of CBRE has any authority to make any representation or warranty whatsoever in relation to this property. Unless otherwise stated, all priced and rents are quoted exclusive of VAT. Date of publication: November 2017.